

1		
Description	Material	Finish
Body	Brass	Gold
Socket	BE CU	Gold
Insulation	Teflon	Teflon
Crimp Ring	Brass	Gold
Nut	Brass	Gold
Washer	Brass	Gold
Support	Brass	Gold
Spacer	Teflon	Teflon

RECOMMENDED CABLE STRIPPING DIMENSIONS

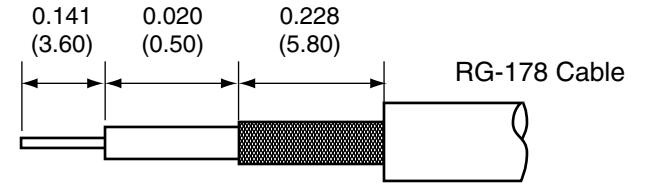

SIDE VIEW

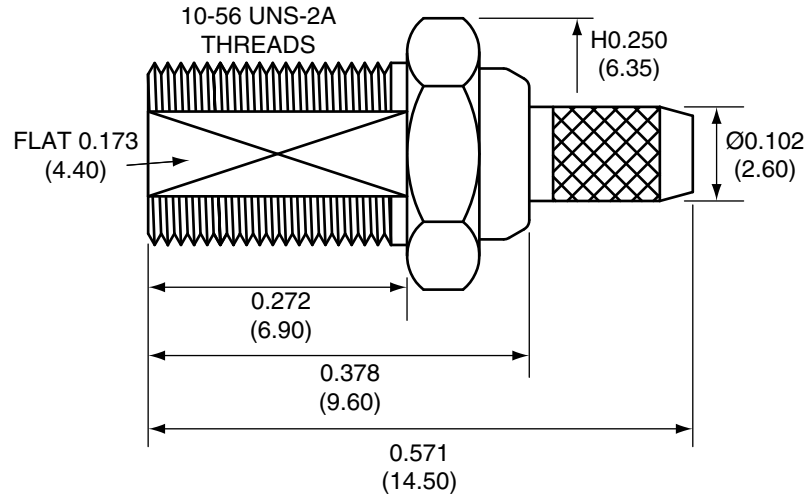

SOCKET

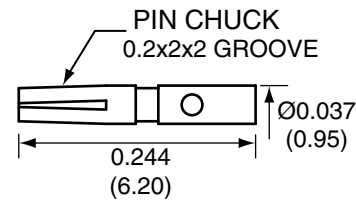

SPACER



SUPPORT

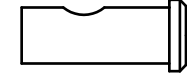

NUT

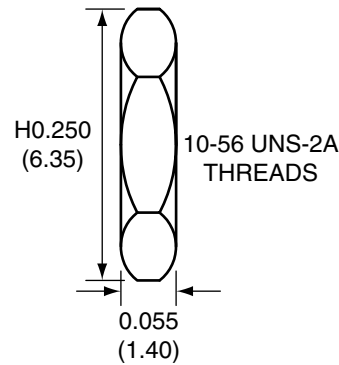

WASHER

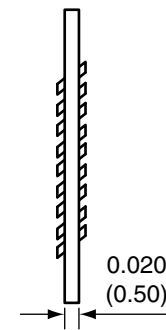

RECOMMENDED MOUNTING HOLE

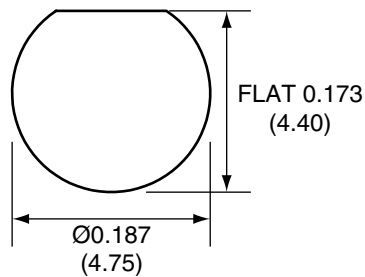

CONMCX005-R178 ASSEMBLY INSTRUCTIONS

- Strip the cable to the recommended dimensions.
- Solder the support onto the braid.
- Place the spacer onto the center conductor.
- Solder or crimp the socket onto the center conductor.
- Insert the socket, center conductor, spacer, and support into the body until the top of the socket is even with the white insulation in the body.
- Crimp the tail of the body onto the support with a hex crimp tool.

Title MCX FEMALE BULKHEAD MOUNT  
CABLE END CRIMP FOR RG178 CABLE

Part No. CONMCX005-R178 Revision: 1.0

Dimensions: INCHES (mm) Date: 6/7/2006

CONNECTOR CITY  
159 ORT LANE  
MERLIN, OR 97532  
PH (541)-471-6256  
FAX (541)-471-6251

**CONNECTOR CITY**  
THE VALUE OF CONNECTIONS

Sheet 1 of 1